



Unit 4/1 Rocklea Drive  
Port Melbourne Vic 3207  
Australia  
1300 109 108  
[www.traxxcp.com.au](http://www.traxxcp.com.au)



## OPERATIONS MANUAL

### TM-GVS30L VACUUM CLEANER

## CONTENTS

The contents of this Operations Manual are the copyright of the publisher and may not be reproduced (even extract) unless permission is granted. Traxx Construction Products has composed this manual with accuracy. However, mistakes may occur or articles may be changed. Traxx Construction Products is not responsible for mistakes or deviations of figures, graphics or any other information found in this instruction manual.

1. USER INSTRUCTIONS .....	3
2. INSTRUCTIONS FOR DRY VACUUM CLEANING.....	3
3. INSTRUCTIONS FOR WET VACUUM CLEANING.....	3
4. SAFETY RULES & CAUTIONS.....	3
5. CLEANING AND MAINTENANCE.....	3
6. TROUBLESHOOTING .....	3
7. PARTS LIST.....	4
8. TECHNICAL PARAMETERS .....	5

## USER INSTRUCTIONS

- 1) Make sure that the power supply in the building is identical to that shown on the rating label/voltage plate.
- 2) Assemble the suction hose, tubes and suitable floor tool/nozzle.
- 3) Connect suction hose to tank connector of the vacuum cleaner.
- 4) Place suction head on tank so that the mains cable is opposite to the suction hose connection.

## INSTRUCTIONS FOR DRY VACUUM CLEANING

- Before vacuuming dry dust, make sure that the cloth bag is always fitted, regardless of whether a paper dust bag is used or not.
- Empty dust from the tank as required.

## INSTRUCTIONS FOR WET VACUUM CLEANING

- Always make sure that the cloth filter bag and paper bags are removed before vacuuming water.
- Empty tank as required.

## SAFETY RULES & CAUTIONS

- 1) The machine is not suitable for picking up dusts or liquids which are explosive, flammable, poisonous or in any way represent danger to health.
- 2) Check the mains cable to ensure it is ok before using the machine. Every care must be taken to avoid damaging the mains cable. If the cable is broken, damaged or becomes loose in any way, then it must be repaired or replaced before use. In case of replacement, the same quality of cable must be used.
- 3) All plugs and sockets used must be waterproof. Use only in 220V/240V plug and points.
- 4) Do not use the machine outdoors.
- 5) This appliance is not intended for use by persons (including children) with reduced physical, sensory or mental capabilities or lack of experience or knowledge, unless they have been given supervision or instruction concerning use of the appliance by a person responsible for their safety.
- 6) Children should be supervised to ensure that they do not play with the appliance.

## CLEANING AND MAINTENANCE

### THE MACHINE MUST BE SWITCHED OFF BEFORE PLUGGING INTO POWER SOCKET.

- 1) Always turn the machine off and disconnect the plug from the power supply before cleaning or maintenance.
- 2) Always keep the machine and dry as possible – don't leave it for a long time with dust or water.
- 3) Clean the cloth bag thoroughly either by beating or brushing it.
- 4) The cloth bag can be washed with a little washing powder in lukewarm water and must be dried thoroughly before re-use.
- 5) The cloth bag must be replaced according to the level of use.

## TROUBLESHOOTING

- 1) The dust bag is too dirty / Clean the dust bag thoroughly.
- 2) There is too much waste in the dust bag or in the machine / Remove and dispose of all the waste.
- 3) The suction hose or the tank connector is blocked / Clear out the blockage.

## PARTS LIST

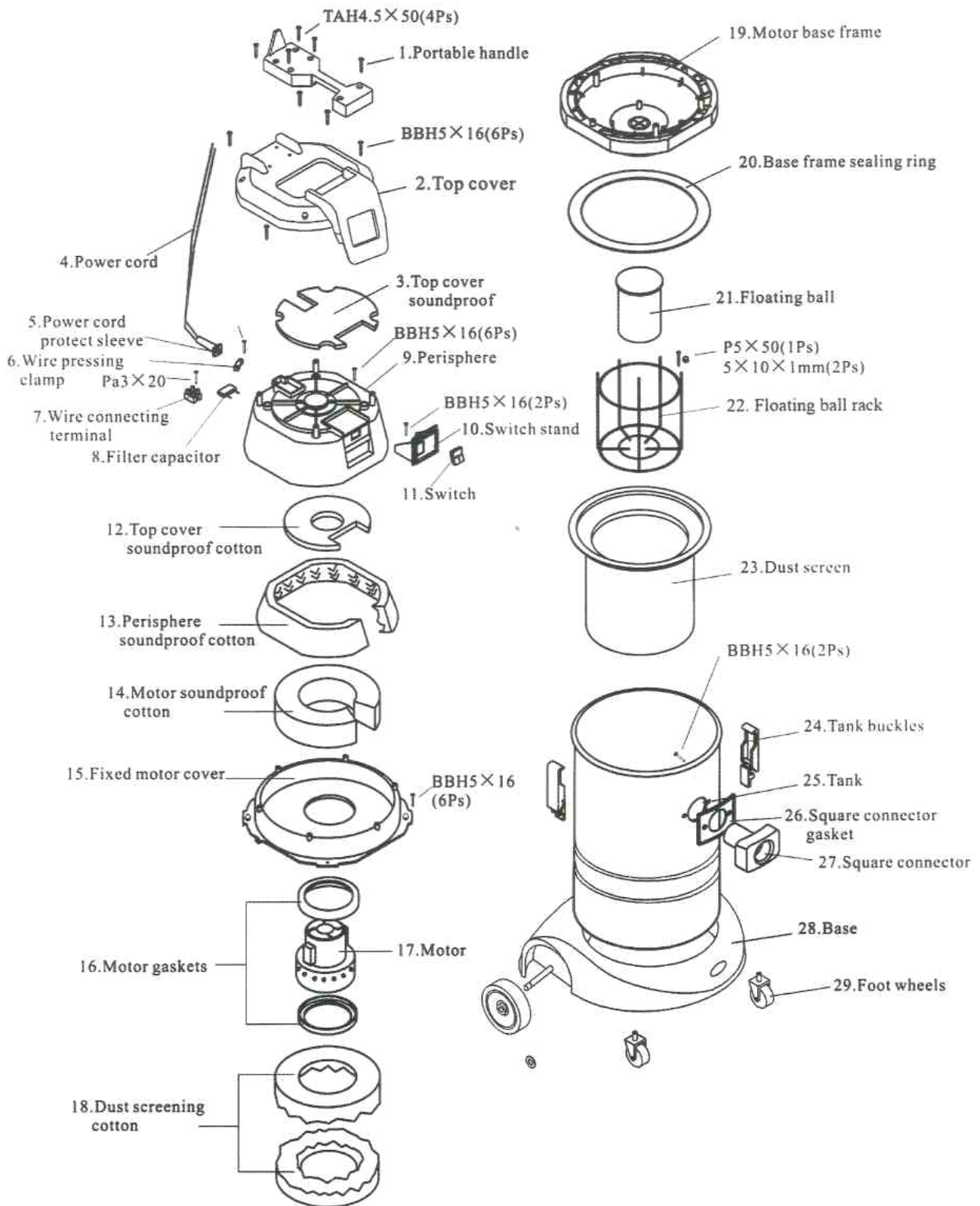

## VC30L VACUUM CLEANER

TECHNICAL SPECIFICATIONS	
Model	VC30L
	Stainless Steel Tank
Power	1000W, single phase
Cooling System	Circulating
Capacity	30L
Height	78cm
Diameter	34.5cm
Air Flow	53L/s
Vacuum Suction	230 mbar
Accessories	40mm
Function	Wet & Dry vacuuming
Voltage	220/240V
Length of Cable	7m



### STANDARD ATTACHMENTS:

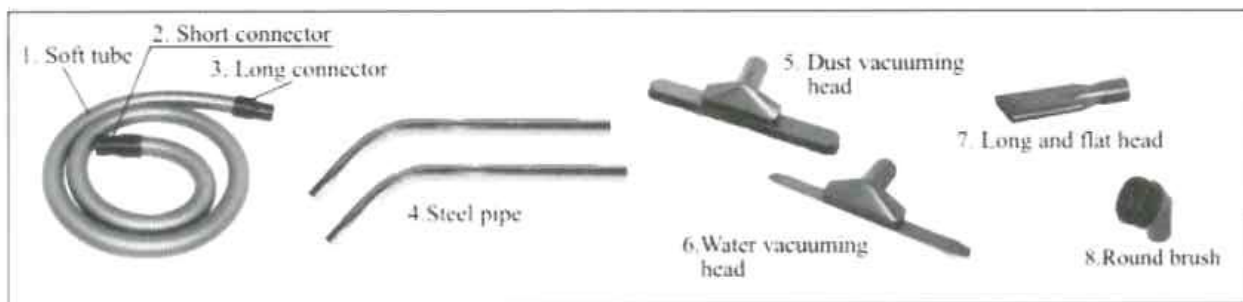



**Unit 4/1 Rocklea Drive  
Port Melbourne Vic 3207**

**1300 109 108**

**[www.traxxcp.com.au](http://www.traxxcp.com.au)**